

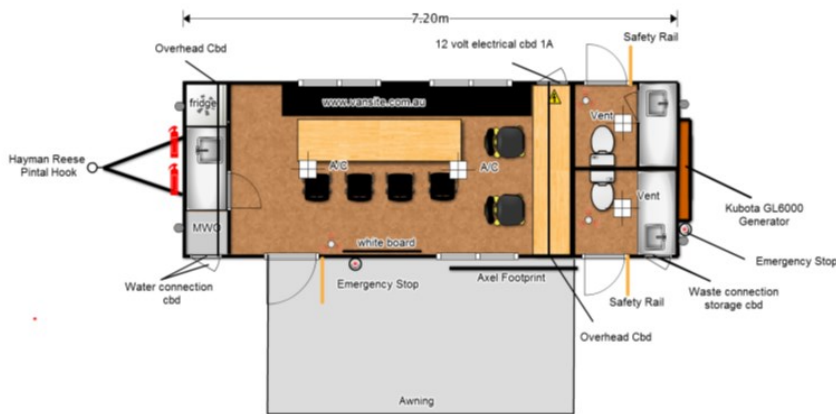

Mobile Site Office Van

Pacific Hire's Site Vans are renowned for their durability, dependability and toughness, which make our Vans the ideal solution for your short or long term hire.



Standard Features:

- Reverse cycle air conditioning
- Security windows with roll down blinds.
- 6kVA lowboy Kubota Generator
- In Cab stop / start control panel
- 490L Potable Water Tank
- 500L Waste Tank
- Solar system that runs Fridge, lights, toilets
- Kitchenette that includes, Sink, Microwave, Kettle, Fridge Freezer, Water Cooler
- 150L Diesel Tank
- 14Ft Awning
- Overhead storage including bag rack holders.
- Auto pump shut off.
- Smoke Alarms throughout
- Fire extinguisher
- ID signage
- Wheel nut indicators
- Wheel Chocks
- Spare wheels x 2
- Wheel brace, jack, drop down leg and spare wheel winders
- Fold down steps and pop out handrails
- Mobile site Office Manual
- Ventia in cab brake controller
- E-stops and lockout switches
- External spot lights
- White and Cork boards
- Radio with Bluetooth connection

7.2 RG Series Technical Specifications:

- **Tare Weight:** 3460kgs when Van is completely empty
- **ATM:** 4500kgs maximum weight with all tanks full
- **Tow Ball Weight:** 360kgs
- **Connection Type:** 70mm Pintel Hook
- **Tow Ball connection Height:** 580mm
- **Body length:** 7200mm
- **Interior Length:** 7100mm
- **Travel Length:** 8900mm
- **Width:** 2490mm
- **Total Travel Height:** 3550mm
- **Interior Height:** 2300mm
- **Van Wind Rating:** Region B Terrain Category 3



www.pacifichire.com.au

1300 722 132